

datavideo

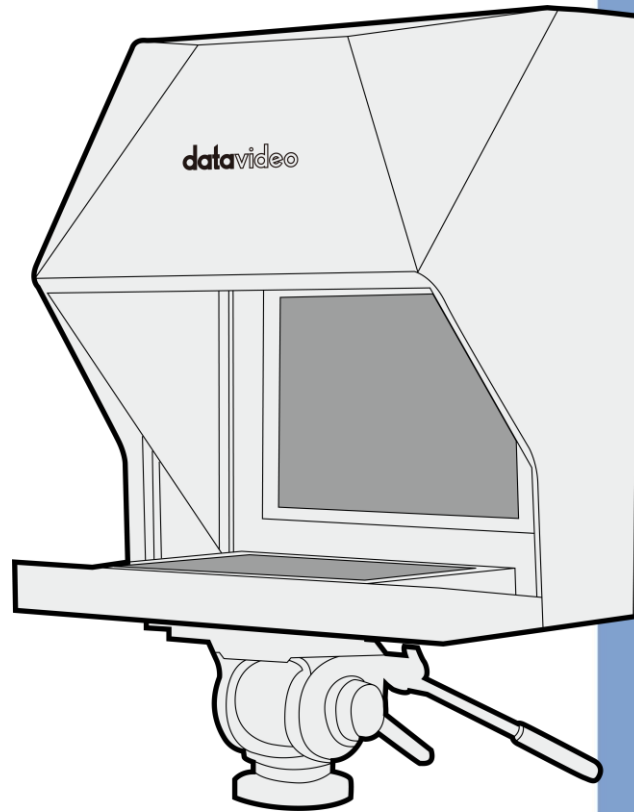

**TABLET PTZ
TELEPROMPTER KIT
TP-950**

Instruction Manual

www.datavideo.com

Contents

FCC COMPLIANCE STATEMENT 3

WARNINGS AND PRECAUTIONS..... 3

 GLASS – HANDLE WITH CARE..... 3

WARRANTY 4

 STANDARD WARRANTY..... 4

 REGISTER FOR 5 YEAR WARRANTY 4

 DISPOSAL 4

 PACKING LIST..... 5

PRODUCT OVERVIEW 7

 FEATURES..... 7

ASSEMBLY – TP-950 8

CAMERA EXPOSURE AND 70/30 MIRROR GLASS13

CLEANING 70/30 GLASS13

OPTIONAL REMOTE CONTROLS14

DVPROMPTER PLUS APP.....14

SPECIFICATIONS.....15

SERVICE AND SUPPORT16

Disclaimer of Product and Services

The information offered in this instruction manual is intended as a guide only. At all times, Datavideo Technologies will try to give correct, complete and suitable information. However, Datavideo Technologies cannot exclude that some information in this manual, from time to time, may not be correct or may be incomplete. This manual may contain typing errors, omissions or incorrect information. Datavideo Technologies always recommend that you double check the information in this document for accuracy before making any purchase decision or using the product. Datavideo Technologies is not responsible for any omissions or errors, or for any subsequent loss or damage caused by using the information contained within this manual. Further advice on the content of this manual or on the product can be obtained by contacting your local Datavideo Office or dealer.

FCC Compliance Statement

This device complies with part 15 of the FCC rules. Operation is subject to the following two conditions:

1. This device may not cause harmful interference, and
2. This device must accept any interference received, including interference that may cause undesired operation.

Warnings and Precautions



1. Read all of these warnings and save them for later reference.
2. Follow all warnings and instructions marked on this unit.
3. Unplug this unit from the wall outlet before cleaning. Do not use liquid or aerosol cleaners. Use a damp cloth for cleaning.
4. Do not use this unit in or near water.
5. Do not place this unit on an unstable cart, stand, or table. The unit may fall, causing serious damage.
6. Slots and openings on the cabinet top, back, and bottom are provided for ventilation. To ensure safe and reliable operation of this unit, and to protect it from overheating, do not block or cover these openings. Do not place this unit on a bed, sofa, rug, or similar surface, as the ventilation openings on the bottom of the cabinet will be blocked. This unit should never be placed near or over a heat register or radiator. This unit should not be placed in a built-in installation unless proper ventilation is provided.
7. This product should only be operated from the type of power source indicated on the marking label of the AC adapter. If you are not sure of the type of power available, consult your Datavideo dealer or your local power company.
8. Do not allow anything to rest on the power cord. Do not locate this unit where the power cord will be walked on, rolled over, or otherwise stressed.
9. If an extension cord must be used with this unit, make sure that the total of the ampere ratings on the products plugged into the extension cord do not exceed the extension cord rating.
10. Make sure that the total amperes of all the units that are plugged into a single wall outlet do not exceed 15 amperes.
11. Never push objects of any kind into this unit through the cabinet ventilation slots, as they may touch dangerous voltage points or short out parts that could result in risk of fire or electric shock. Never spill liquid of any kind onto or into this unit.
12. Except as specifically explained elsewhere in this manual, do not attempt to service this product yourself. Opening or removing covers that are marked "Do Not Remove" may expose you to dangerous voltage points or other risks, and will void your warranty. Refer all service issues to qualified service personnel.
13. Unplug this product from the wall outlet and refer to qualified service personnel under the following conditions:
 - a. When the power cord is damaged or frayed;
 - b. When liquid has spilled into the unit;
 - c. When the product has been exposed to rain or water;
 - d. When the product does not operate normally under normal operating conditions. Adjust only those controls that are covered by the operating instructions in this manual; improper adjustment of other controls may result in damage to the unit and may often require extensive work by a qualified technician to restore the unit to normal operation;
 - e. When the product has been dropped or the cabinet has been damaged;
 - f. When the product exhibits a distinct change in performance, indicating a need for service.

GLASS – Handle with Care



This product contains a sheet of 70/30 mirror glass please handle it with care.

To avoid a risk of damage or injury please follow this instruction manual and use caution when transporting, un-packing, cleaning, assembling or dis-assembling this part of the product.

Warranty

Standard Warranty

- Datavideo equipment is guaranteed against manufacturing defects for **one (1) year** from the date of purchase.
- A valid purchase invoice or other proof of purchase must be provided when requesting warranty service.
- The warranty period begins on the actual purchase date. If the purchase date cannot be verified, the warranty period will begin **thirty (30) days after shipment** from a Datavideo office.
- Non-Datavideo branded products (products without the Datavideo logo) are covered by a **one-year warranty** from the date of purchase.
- Damage caused by accident, misuse, unauthorized repair, or exposure to sand, grit, or water is **not covered** under warranty.
- Virus or malware infections on computer systems are **not covered** under warranty.
- Any issues caused by unauthorized third-party software installations that are not required by Datavideo systems are **not covered** under warranty.
- All shipping, mailing, or transportation costs, including insurance, are the responsibility of the owner unless otherwise stated.
- **Teleprompter glass is not covered** under warranty.
- Accessories, including **headphones, cables, batteries, metal parts, housings, protective**

cases, cable reels, and consumable items, are not covered under warranty.

- Warranty is valid only in the country or region of purchase.
- All other claims **not explicitly stated** are not covered.
- Your statutory rights remain unaffected.

Register for 5 Year Warranty

- Starting January 1, 2026, all Datavideo products that are successfully registered on the Datavideo official website are eligible for a **free four-year extended warranty**, in addition to the standard one-year warranty, for a total of **five years of coverage**.
- **Only registrations completed through the Datavideo official website qualify** for the five-year warranty. Registrations completed through local Datavideo offices, resellers, or authorized distributors **are not eligible**.
- Certain parts with limited service life — including **LCD panels, DVD drives, hard drives, solid-state drives, SD cards, USB thumb drives, lighting equipment, non-PCIe cards, and third-party PC components** — are covered by a **one-year warranty only** and are **not eligible** for the extended warranty.
- **Camera modules** are covered by a **three-year warranty from the date of purchase**.



Disposal

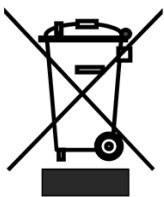

For EU Customers only - WEEE Marking

This symbol on the product or on its packaging indicates that this product must not be disposed of with your other household waste. Instead, it is your responsibility to dispose of your waste equipment by handing it over to a designated collection point for the recycling of waste electrical and electronic equipment. The separate collection and recycling of your waste equipment at the time of disposal will help to conserve natural resources and ensure that it is recycled in a manner that protects human health and the environment. For more information about where you can drop off your waste equipment for recycling, please contact your local city office, your household waste disposal service or the shop where you purchased the product.



CE Marking is the symbol as shown on the left of this page. The letters "CE" are the abbreviation of French phrase "Conformité Européene" which literally means "European Conformity". The term initially used was "EC Mark" and it was officially replaced by "CE Marking" in the Directive 93/68/EEC in 1993. "CE Marking" is now used in all EU official documents.

Packing List

Item	Description	Quantity
A	Adjustable Mounting Bracket with locking lever	1
F	TP-950 metal base tray with tripod plate	1
G	150 x 150 PTZ Scissor Lift	1
H	Cloth Hood	1
I	Medium CRV hex tool to remove 90 degree joining blacks from item Q	1
J	9mm long ¼ thumb screw with red dot	1
K	9mm long ¼ thumb screw with washers	1
L	35mm long thumb screws	12
M	15mm long thumb screws	6
N	16mm long thumb screw	1
O	3/8 to ¼ adapter	1
P	565mm Vertical extrusions	4
Q	475mm horizontal extrusions with 90 degree joining blocks	2
R	325mm glass support extrusions with single end caps	2
S	250mm PTZ lift extrusions with both end caps	2
T	70/30 mirror glass	1
U	Glass support bar	1
V	Spare black plastic end caps	4
W	Spare M6*14mm screws	2
Y	Small CRV hex tool to remove the tripod plate from item F	1



NOTE: Depending on your order, your TP-950 kit could have been supplied with one of a range of remote controls – for more information on the remote controls please speak with your local Datavideo supplier or check our website www.datavideo.info for details.



Product Overview

The TP-950 teleprompter is designed specifically for PTZ cameras. Mounting the PTZ upside down removes the operational limitations of a PTZ camera within a prompter, the PTZ has greater movement in the shots it can achieve.

TP-950 features an adjustable mounting bracket that can support tablets up to 15.6 inches in size.

Features

- Adjustable PTZ lift, supports all PTZ cameras on the market
- Expandable mounting bracket system allows simple but secure installation of tablets up to 15.6"
- Quick and simple assembly that requires no special tooling.
- Fully controllable via LAN
- Optional hardware controllers available

Assembly – TP-950

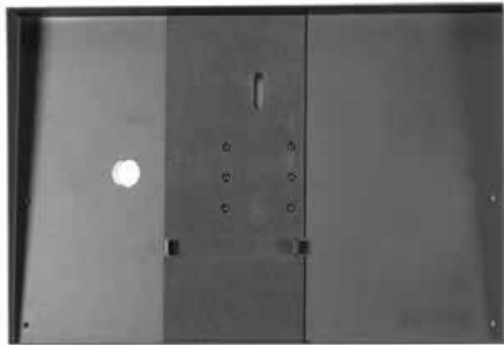

1. Grab TP-950 metal base tray (Item F) and lay flat on surface such as a table.

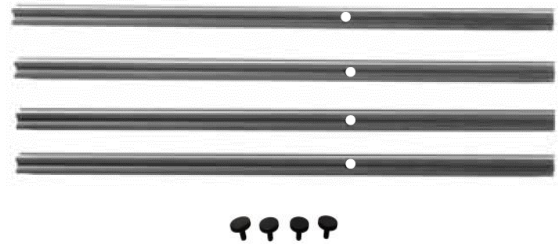

2. Grab 4 x 565mm vertical extrusions (Item P) and 4 x 15mm thumb screws (Item M).



Note: Make sure screw opening closest to the end is facing away from metal base tray (Item F).



3. Attach the four 565mm vertical extrusions (Item P) to metal base tray (Item F) using the 15mm thumb screws (Item M).



4. Grab two 475mm horizontal extrusions (Item Q) & four 35mm thumb screws (Item L).



Attach the horizontal extrusions using the four 35mm thumb screws (Item L)

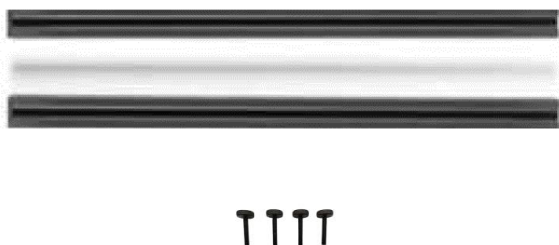

5. Grab two 325mm glass support extrusions with single end caps (Item R) and four 35mm thumb screws (Item L).



6. Use the four 35mm thumb screws (Item L) to attach screws to the vertical extrusions.



7. Grab two 325mm glass support extrusions (Item R) and four 35mm thumb screws (Item L).

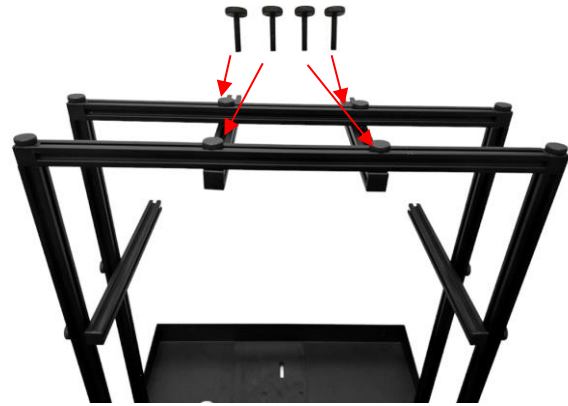

8. Use the four 35mm thumb screws (Item L) to attach screws to the vertical extrusions.

9. Top view should look like this.



10. Remove square black plastic caps from extrusions 1 & 2 for PTZ.

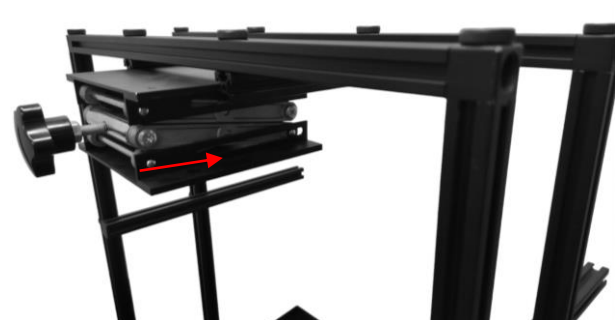

11. Insert the 150 x 150 PTZ scissor lift (Item G) in between the extrusions (1 & 2) as shown above. Replace the square black plastic caps.

12. Lock the position of the 150 x 150 PTZ Scissor Lift (Item G) with the 16mm long screw (Item N).

Note: If item N does not lock, try loosening the two 35mm thumb screws (Item L) on extrusion, push it towards extrusion 1 and re-tighten the two 35mm thumb screws (Item L).





13. With the PTZ Scissor Lift locked, now lay on flat table. Attach/screw quick release plate of your tripod to the bottom of the TP-950 metal base plate (Item F).

14. Once installed, mount onto your tripod.

Note: Tripod must be able to uphold over 25 lbs (tripod not included).



15. Grab glass support bar (Item U) and two 15mm thumb screws (Item M).



16. Attach the glass support bar (Item U) to the horizontal extrusions using the two 15mm Thumb screws.

Alternatively, you can use the Spare M6*14mm screws (Item W) and the Medium CRV hex tool (Item Z) to attach the glass support bar to the vertical extrusions. This will allow the cloth hood to fit tighter to the frame.



17. Leave about a quarter or an inch of space between glass support bar (Item U) and glass support extrusion (Item R).



18. Grab 70/30 mirror glass (Item T). Carefully remove plastic covering.



19. Place mirror glass carefully in the center.

Note: You will see a red dot and a green dot on the mirror glass. The green dot should face the talent.



20. Fasten the space between glass support bar (Item U) and glass support extrusion (Item R).



21. Grab the Adjustable Mounting Bracket with locking lever (Item A).

22. Install your tablet in the Adjustable Mounting Bracket with locking lever (Item A).

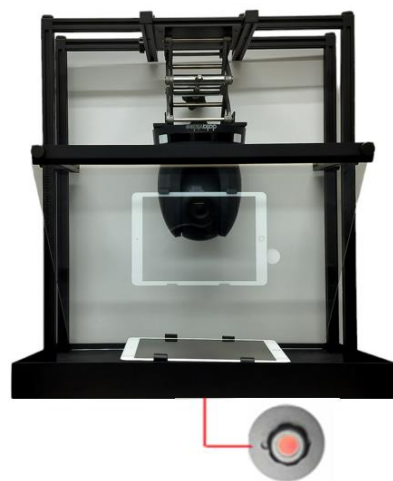

23. Install the Adjustable Mounting Bracket with locking lever (Item A) by inserting the 9mm long 1/4 thumb screw with red dot (Item J) through the slot in the TP-950 metal base tray with tripod plate (Item F).



24. Now bring the PTZ scissor lift down (Item G) by turning the knob clockwise.



25. Install your PTZ camera (camera not included) upside down onto the PTZ scissor lift (Item G).



26. Install your PTZ camera onto PTZ scissor lift (Item G) with thumb screw (Item K).



27. Adjust the position of the 150 x 150 PTZ Scissor Lift (Item G) as required.

Tip: Position the PTZ lens as close to the 70/30 mirror glass as possible to achieve the best pan range.



28. Grab cloth cover (Item H).

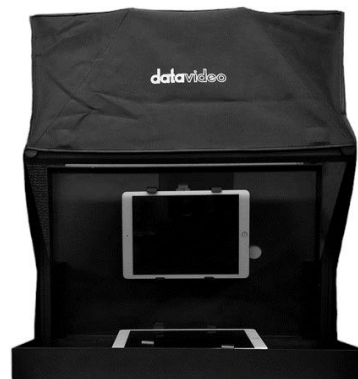

29. Install the cloth hood (Item H). The hood is secured to the inside of the TP-950 metal base tray with tripod plate (Item F) and glass support bar (Item U) via integral magnets.

The rear of the hood can be expanded if the PTZ camera or cables protrude past the rear of the TP-950 frame.

Camera Exposure and 70/30 Mirror Glass

After setting up the camera with the 70/30 glass in front of the lens adjust the camera set up and white balance. This is because the 70/30 Glass affects the camera exposure by approximately 1 stop almost like the effect of a neutral density filter. Consult your camera manual for further help and advice with its exposure and white balance settings.

Cleaning 70/30 Glass



This product contains a sheet of 70/30 glass please handle it with care.

To avoid a risk of damage or injury please follow this instruction manual and use caution when transporting, un-packing, cleaning, assembling or dis-assembling this part of the product.

Datavideo recommend cleaning the glass regularly to remove dust and finger print marks. This will ensure the best image quality is recorded when the camera is looking through the glass.

Never attempt to clean the glass whilst it is mounted in the prompter instead remove it carefully from the prompter, clean the glass and then re-install it into the prompter frame. Handle the glass carefully using the cloth covered edges of the glass at all times.

To retain the required qualities of the glass and to avoid scratching the glass during cleaning.

- **Never use** abrasive cloths, pads or abrasive based cleaning fluids on the glass.
- **Never use** cleaning fluids based on an acid or vinegar solution.

Place the glass on a soft, stable, dirt and lint free work surface such as a table with a clean cloth already laid out on it. Then use a second clean, lint free, soft cloth to clean the glass.

Do not apply cleaning fluids to the glass directly, instead apply or spray a small amount of the cleaning fluid onto the cloth. Proceed to clean the glass and work in a light circular motion with the cloth. Ensure all finger marks and streaks are gone before turning the glass over and repeating with the other side.

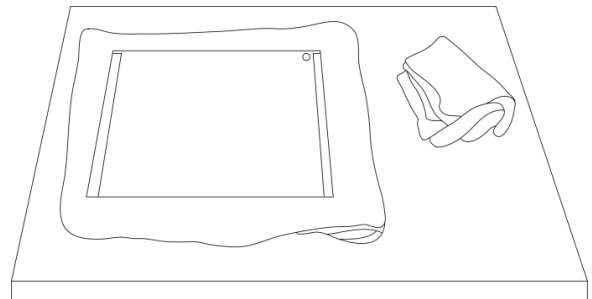

Optional Remote Controls

In addition to using a laptop or tablet to control and monitor the TP-950 in real time over IP, optionally you can also use the Datavideo WR-500 handheld controller, the Datavideo FS-30-foot switch controller, generic 2.4 GHz wireless presentation clickers or the Contour Shuttle Xpress.



Please see the teleprompter app instruction manual for details on the optional hardware compatible with your teleprompter model.

dvPrompter Plus App

dvPrompter Plus is a fully featured teleprompter app built to be both powerful and user-friendly.

It comes with an advanced rich text editor, allowing you to customize font size, style, colour, alignment, borders, and line spacing.

The app also offers a wide range of options for remote control, monitoring, and content upload.

For detailed guidance on software operation, please consult the teleprompter app instruction manual.

Specifications

Device Used	Apple iPads Android Tablets	
Multi-language Support	English Dutch Spanish Portuguese Russian	
Supported Languages	Unicode – All languages supported	
Expandable mounting bracket	145 mm (Minimum tablet width) 265 mm (Maximum tablet width)	
Prompter Size (Max)	Width	535
	Height	590
	Depth	350
Weight	Net Weight	10.3KG
	Gross Weight	13.3KG
Operating Temperature	0 – 40°C	
Gift box size	610x510x2650 mm	
Power	12V 2A DC (Mains adapter supplied)	

Service & Support

It is our goal to make owning and using Datavideo products a satisfying experience. Our support staff is available to assist you to set up and operate your system. Contact your local office for specific support requests. Plus, please visit www.datavideo.com to access our FAQ section.

Please visit our website for latest manual update.

www.datavideo.com/product/TP-950

datavideo
www.datavideo.com



@DatavideoUSA @DatavideoIndia2016
@DatavideoEMEA @Datavideojapan
@DatavideoTaiwan @DatavideoLatam
@DatavideoAsia @DatavideoBrasil



@Datavideo
@Datavideo_EMEA
@Datavideo_Taiwan



@DatavideoUSA
@DVTWDVCN



@DatavideoUSA
@DatavideoEurope

All the trademarks are the properties of their respective owners.
Datavideo Technologies Co., Ltd. All rights reserved 2020

Dec-30.2025
Ver.: E3